

WAFER INSPECTION ROTARY TABLE

650301

WAFER INSPECTION
OPTICAL METROLOGY

DYNAMIC RUNOUT SUB 20 NM

CONFIGURABLE CHUNK TABLE

Specification	
Maximum Speed	6000 RPM
Air Supply Pressure	0.6—0.8 Mpa
Axial Stiffness	≥ 150 N/um
Radial Stiffness	≥ 50 N/um
Axial Load Capacity	≥ 180 N
Radial Load Capacity	≥ 50 N
Synchronous Error Motion (Axial)	≤ 0.1 um
Synchronous Error Motion (Radial)	≤ 0.1 um
Asynchronous Error Motion (Axial)	≤ 0.02 um
Asynchronous Error Motion (Radial)	≤ 0.02 um
Feedback Type	Incremental
Velocity Ripple	$\leq 0.1\%$
Housing Material	Stainless Steel
Weight (Approx)	10 Kg



KEY BENEFITS

- 6000 MIN⁻¹ DC
- THE USE OF DC BRUSHLESS TORQUE MOTORS WITH HIGH RESOLUTION ENCODERS CAN ACHIEVE ANGULAR POSITION RESOLUTIONS BETTER THAN 0.1 ARCSECS
- LIGHTWEIGHT DESIGN, COMPACT STRUCTURE.
- GOOD SPEED STABILITY, HIGH RELIABILITY.
- CONFIGURABLE VACUUM CHUNK TABLE.

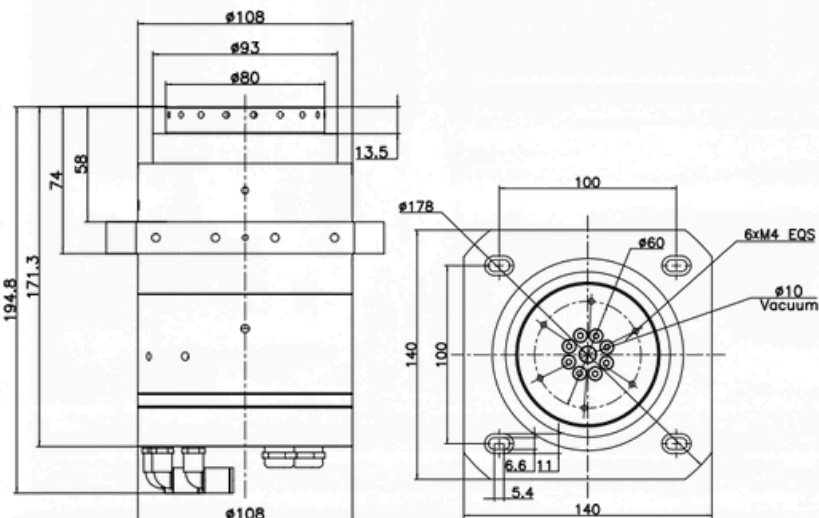

Tel: +44 (0) 1202 894447
Web: www.loadpoint.co.uk